

- Check all dimensions on site prior to commencement of construction
- Figured dimensions to take precedence over stated dimensions
- All works to be in accordance with BCA, Australian Standards, statutory regulations and local authority requirements
- Contractor to confirm structural integrity, stability and feasibility of all units/components prior to manufacture
- Contractor to liaise with 3rd party suppliers to confirm exact requirements including electrical, data, comms and hydraulic requirements and access points

LEGEND:

- 50mm/60mm EXFOLIATED VERSA GREEN GRANITE TREADS AND RISERS
- 50mm SANDBLASTED TURKISH TRAVERTINE NOSING
- MARTIN PLACE PUBLIC DOMAIN LAYOUT AUSTRAL BLACK
- 30mm POLAR WHITE GRANITE SKIRTING
- 6mm SILICONE EXPANSION JOINT - COLOUR TBC
- CTS CUT TO SUIT
- + ^{SOP} TILE SET OUT POINT

KEY PLAN:

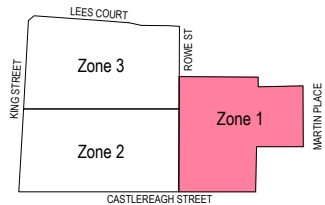

NORTH POINT:

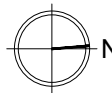

PROJECT:

MLC RETAIL
REDEVELOPMENT STAGE 2

CLIENT:

PROBUILD

Project number:
ATS-286

Project name
MLC RETAIL
REDEVELOPMENT STAGE 2

Drawing name
STAIR 27 STONE WORKS
SHEET 2

Drawing number
ATS-A-227

Scale	AS SHOWN @A3
Revision	2
Date	13.04.2021
Drawn	HH
Issued for	CONSTRUCTION

General Notes:

- Check all dimensions on site prior to commencement of construction
- Figured dimensions to take precedence over scaled dimensions
- All works to be in accordance with BCA, Australian Standards, statutory regulations and local authority requirements
- Contractor to confirm structural integrity, stability and feasibility of all units/components prior to manufacture
- Contractor to liaise with 3rd party suppliers to confirm exact requirements including electrical, data, comms and hydraulic requirements and access points

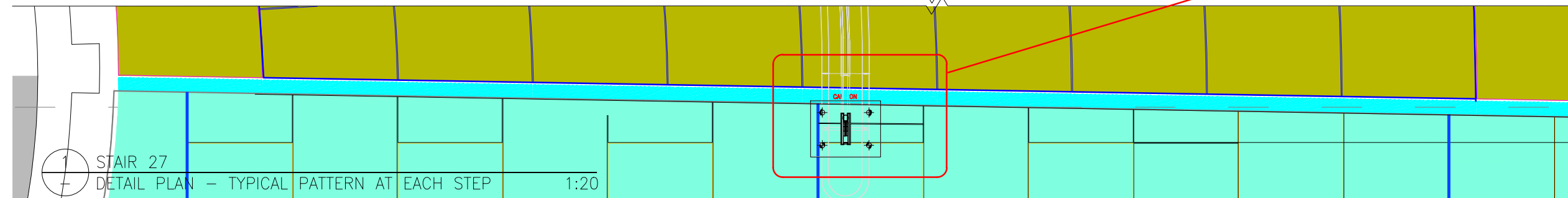
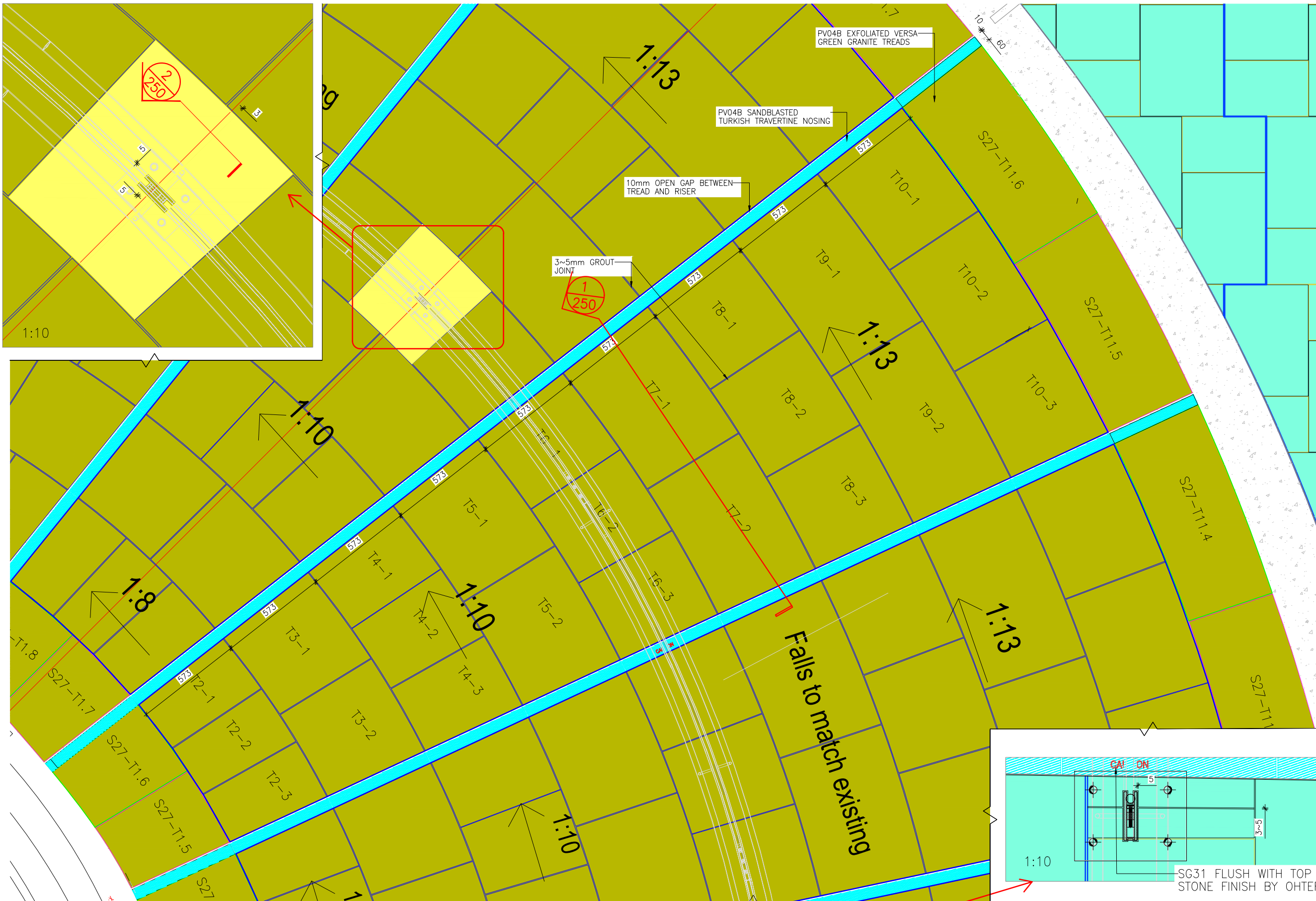

STAIR 27
DETAIL PLAN - TYPICAL PATTERN AT EACH STEP 1:20

- NOTES:
1. ALL DESIGN AND MEASUREMENTS HAVE BEEN TAKEN FROM BASE BUILDING DRAWINGS, DISCREPANCIES BETWEEN DRAWINGS AND SITE CONDITIONS ARE NOT THE SUBCONTRACTOR'S RESPONSIBILITY. ANY COST TO RECTIFY DISCREPANCIES BETWEEN BASE BUILDING DRAWINGS AND SITE CONDITION WILL NOT BE BORNE BY ATS
 2. LOCATION OF ALL NEW AND EXISTING SERVICES HAVE BEEN TAKEN FROM CONSULTANTS DRAWINGS
 3. BUILDER TO CONFIRM EXISTING AND NEW WATERPROOFING SYSTEM IS ADEQUATE AND MEETS CODE AND RELEVANT AUSTRALIAN STANDARDS PRIOR TO ANY TILING WORK COMMENCING
 4. C.O.S. LINE OF EXISTING CONCRETE. STRUCTURAL ENGINEER TO CHECK AND APPROVE PRIOR TO REMOVAL OF EXISTING STRUCTURE BELOW
 5. SOP AT TOP RIGHT CORNER OF THE TILE (AS SHOWN ON ALL DRAWINGS)
 6. HYDRAULIC CONSULTANT TO PROVIDE ADVICE ON DRAINAGE STRATEGY ON STAIR

ABSOLUTE
TILING & STONE

Level 2, 210 Clarence St.
Sydney CBD
Ph. (02) 9896 7727
www.versatile.com.au

LEGEND:

- 50mm/65mm EXFOLIATED VERSA GREEN GRANITE TREADS AND RISERS
- 50mm SANDBLASTED TURKISH TRAVERTINE NOSING
- PV01/PV11A 900x900x30 FLAMED VERSA GREEN GRANITE
- SILICONE EXP JOINT. COLOR TBC
- SOP
- TILE SET OUT POINT

KEY PLAN:

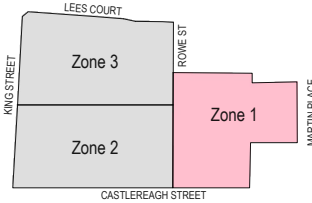

NORTH POINT:



PROJECT:

MLC RETAIL
REDEVELOPMENT STAGE 2

CLIENT:

PROBUILD

Project number:
ATS-286

Project name
MLC RETAIL
REDEVELOPMENT STAGE 2

Drawing name
STAIR 32 STONE WORKS
SHEET 1

Drawing number
ATS-A-230

Scale	AS SHOWN @A3
Revision	2
Date	18.11.2020
Drawn	AA
Issued for	CONSTRUCTION

General Notes:

- Check all dimensions on site prior to commencement of construction
- Figured dimensions to take precedence over scaled dimensions
- All works to be in accordance with BCA, Australian Standards, statutory regulations and local authority requirements
- Contractor to confirm structural integrity, stability and feasibility of all units/components prior to manufacture
- Contractor to liaise with 3rd party suppliers to confirm exact requirements including electrical, date, comms and hydraulic requirements and access points

1 STAIR 32 – LEVEL 8
CONCRETE PROFILE PLAN 1:100

2 STAIR 32 – LEVEL 8
FINISH FLOOR PLAN 1:100

3 STAIR 32 – LEVEL 8
SECTION 1:50

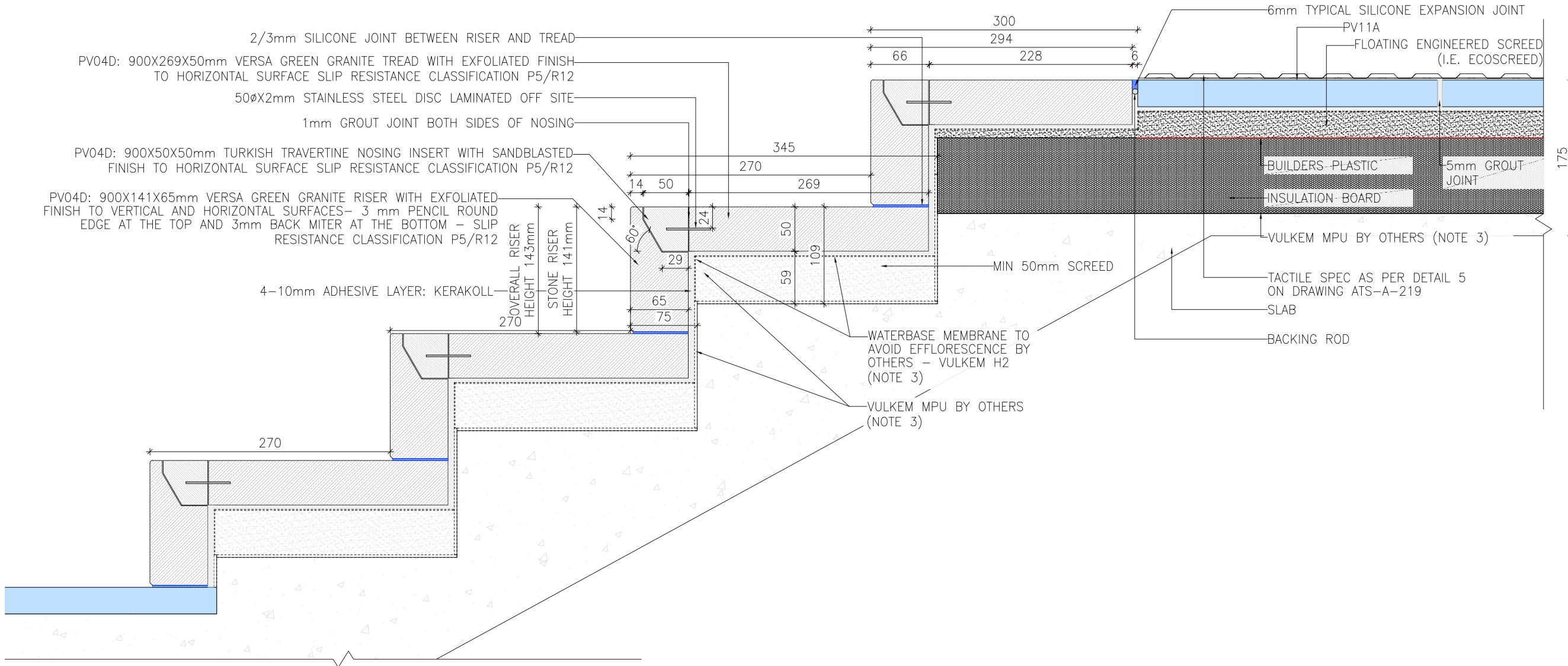

4 STAIR 32 – LEVEL 8
SECTION DETAIL 1:5

NOTES:

1. ALL DESIGN AND MEASUREMENTS HAVE BEEN TAKEN FROM BASE BUILDING DRAWINGS, DISCREPANCIES BETWEEN DRAWINGS AND SITE CONDITIONS ARE NOT THE SUBCONTRACTOR'S RESPONSIBILITY. ANY COST TO RECTIFY DISCREPANCIES BETWEEN BASE BUILDING DRAWINGS AND SITE CONDITION WILL NOT BE BORNE BY ATS
2. LOCATION OF ALL NEW AND EXISTING SERVICES HAVE BEEN TAKEN FROM CONSULTANTS DRAWINGS
3. BUILDER TO CONFIRM EXISTING AND NEW WATERPROOFING SYSTEM IS ADEQUATE AND MEETS CODE AND RELEVANT AUSTRALIAN STANDARDS PRIOR TO ANY TILING WORK COMMENCING
4. C.O.S. LINE OF EXISTING CONCRETE. STRUCTURAL ENGINEER TO CHECK AND APPROVE PRIOR TO REMOVAL OF EXISTING STRUCTURE BELOW
5. SOP AT TOP RIGHT CORNER OF THE TILE (AS SHOWN ON ALL DRAWINGS)
6. HYDRAULIC CONSULTANT TO PROVIDE ADVICE ON DRAINAGE STRATEGY ON STAIR
7. ATS WARRANTS STEP DETAIL AND SUITABILITY

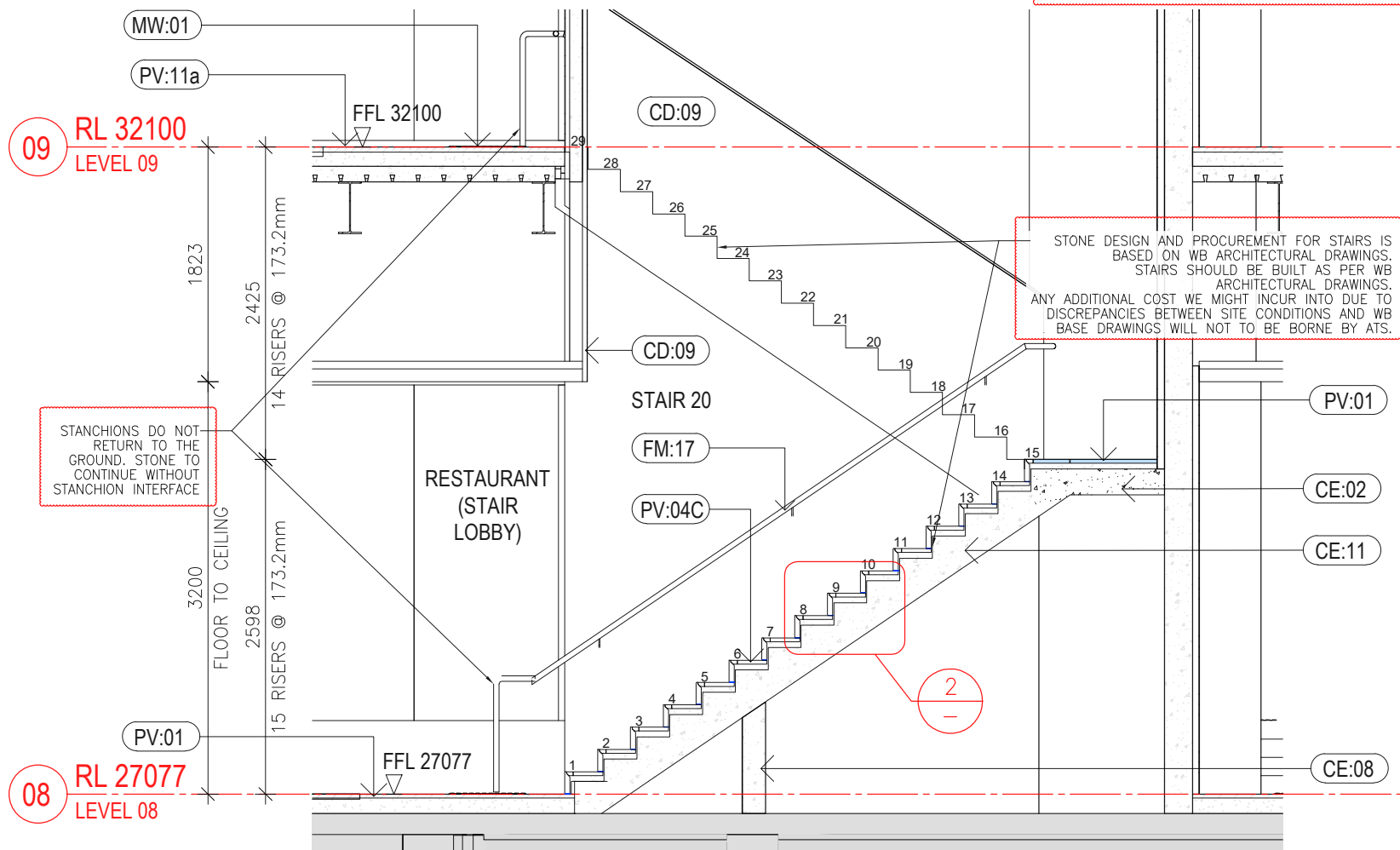

STONE DESIGN AND PROCUREMENT FOR STAIRS IS BASED ON WB ARCHITECTURAL DRAWINGS. STAIRS SHOULD BE BUILT AS PER WB ARCHITECTURAL DRAWINGS. ANY ADDITIONAL COST WE MIGHT INCUR INTO DUE TO DISCREPANCIES BETWEEN SITE CONDITIONS AND WB BASE DRAWINGS WILL NOT TO BE BORNE BY ATS.

1 STAIR 20 – LEVEL 8/9
SECTION 1:50

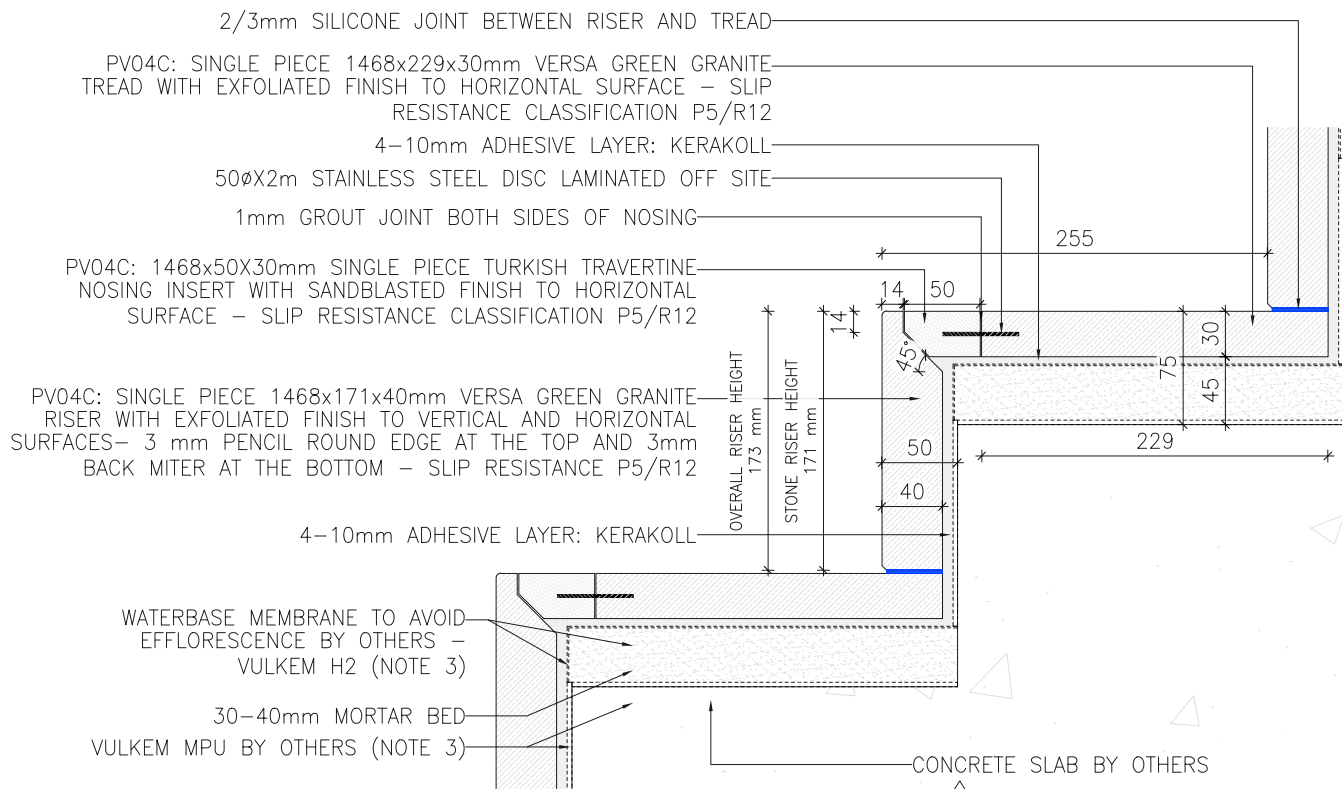

2 STAIR 20 – LEVEL 8/9
DETAIL SECTION 1:5

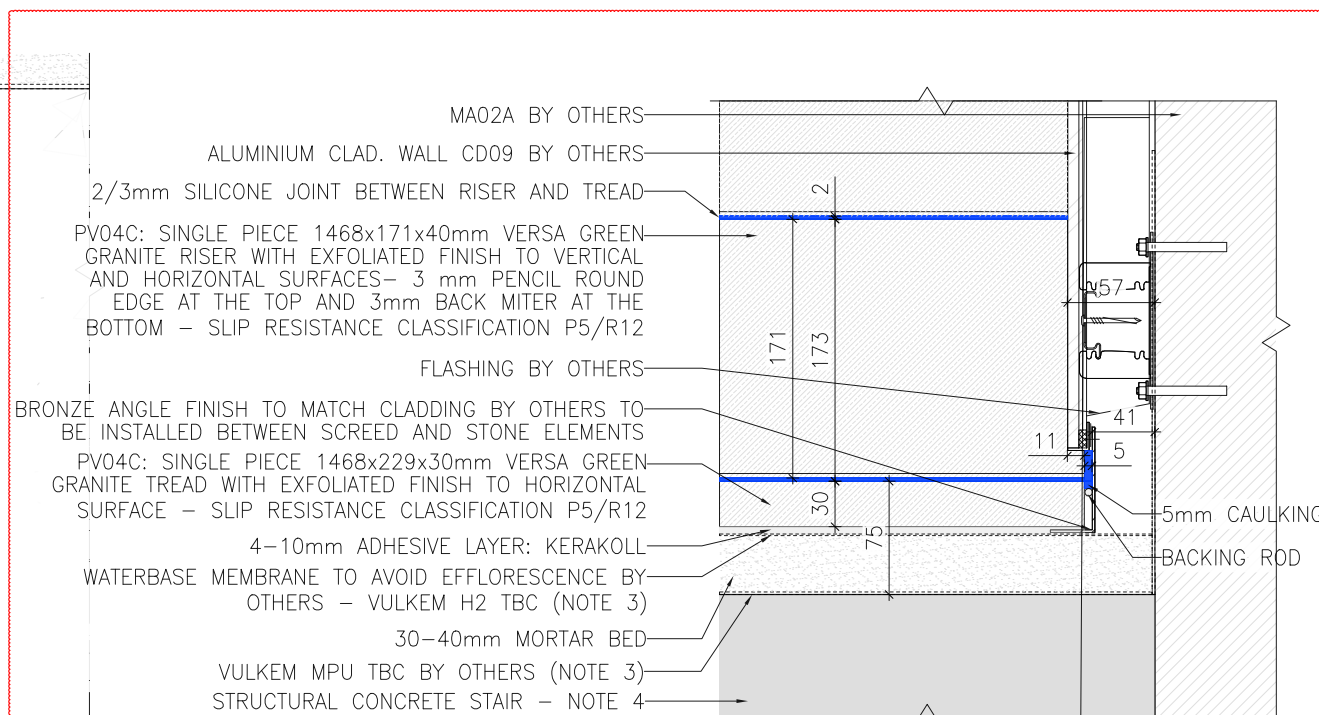

3 STAIR 20 – LEVEL 8/9
SECTION DETAIL 1:5

ABSOLUTE
TILING & STONE

Level 7, 111 Elizabeth St.
Sydney CBD
Ph. (02) 9896 7727
www.versatile.com.au

LEGEND:

- 30mm/40mm EXFOLIATED VERSA GREEN GRANITE TREADS AND RISERS
- 30mm SANDBLASTED TURKISH TRAVERTINE NOSING
- PV01 900x900x30 FLAMED VERSA GREEN GRANITE
- PV02 600x600x30 UNFILLED/BRUSHED TURKISH TRAVERTINE
- PV11a 900x900x30 FLAMED VERSA GREEN GRANITE ON LIGHT WEIGHT SCREED
- SILICONE EXP JOINT. COLOR TBC
- TILE SET OUT POINT

KEY PLAN:

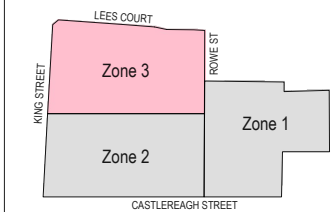

NORTH POINT:

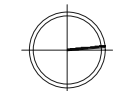

PROJECT:

MLC RETAIL
REDEVELOPMENT STAGE 2

CLIENT:

PROBUILD

Project number:
ATS-286

Project name
MLC RETAIL
REDEVELOPMENT STAGE 2

Drawing name
STAIR 20 STONE WORKS
SHEET 2

Drawing number
ATS-A-231

Scale	AS SHOWN @A3
Revision	2
Date	14.12.2020
Drawn	AA
Issued for	CONSTRUCTION

General Notes:

- Check all dimensions on site prior to commencement of construction
- Figured dimensions to take precedence over scaled dimensions
- All works to be in accordance with BCA, Australian Standards, statutory regulations and local authority requirements
- Contractor to confirm structural integrity, stability and feasibility of all units/components prior to manufacture
- Contractor to liaise with 3rd party suppliers to confirm exact requirements including electrical, data, comms and hydraulic requirements and access points

- NOTES:
1. ALL DESIGN AND MEASUREMENTS HAVE BEEN TAKEN FROM BASE BUILDING DRAWINGS, DISCREPANCIES BETWEEN DRAWINGS AND SITE CONDITIONS ARE NOT THE SUBCONTRACTOR'S RESPONSIBILITY. ANY COST TO RECTIFY DISCREPANCIES BETWEEN BASE BUILDING DRAWINGS AND SITE CONDITION WILL NOT BE BORNE BY ATS
 2. LOCATION OF ALL NEW AND EXISTING SERVICES HAVE BEEN TAKEN FROM CONSULTANTS DRAWINGS
 3. BUILDER TO CONFIRM EXISTING AND NEW WATERPROOFING SYSTEM IS ADEQUATE AND MEETS CODE AND RELEVANT AUSTRALIAN STANDARDS PRIOR TO ANY TILING WORK COMMENCING
 4. C.O.S. LINE OF EXISTING CONCRETE. STRUCTURAL ENGINEER TO CHECK AND APPROVE PRIOR TO REMOVAL OF EXISTING STRUCTURE BELOW
 5. SOP AT TOP RIGHT CORNER OF THE TILE (AS SHOWN ON ALL DRAWINGS)
 6. HYDRAULIC CONSULTANT TO PROVIDE ADVICE ON DRAINAGE STRATEGY ON STAIR

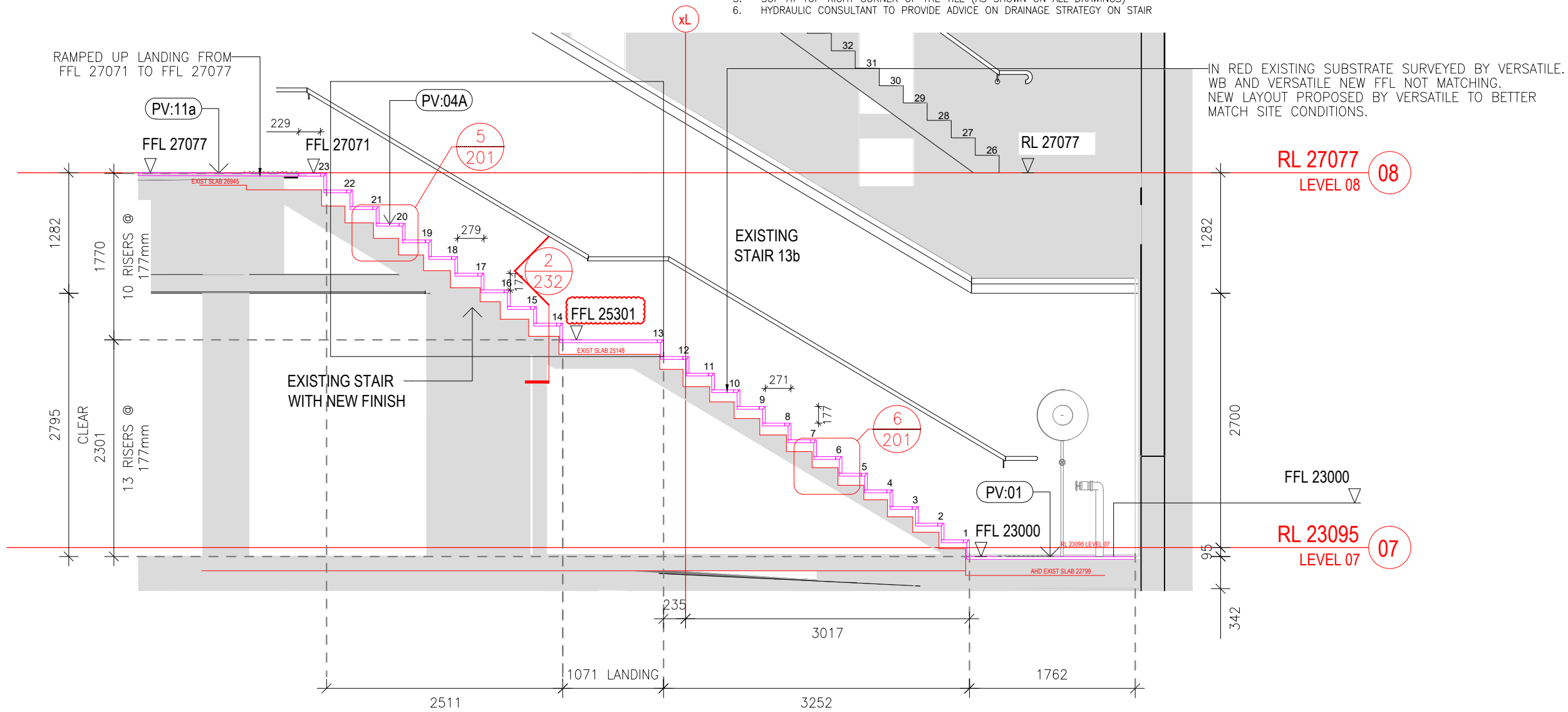

1 STAIR 13b WEST PLANT ROOM – LEVEL 7/8
SECTION 1:50

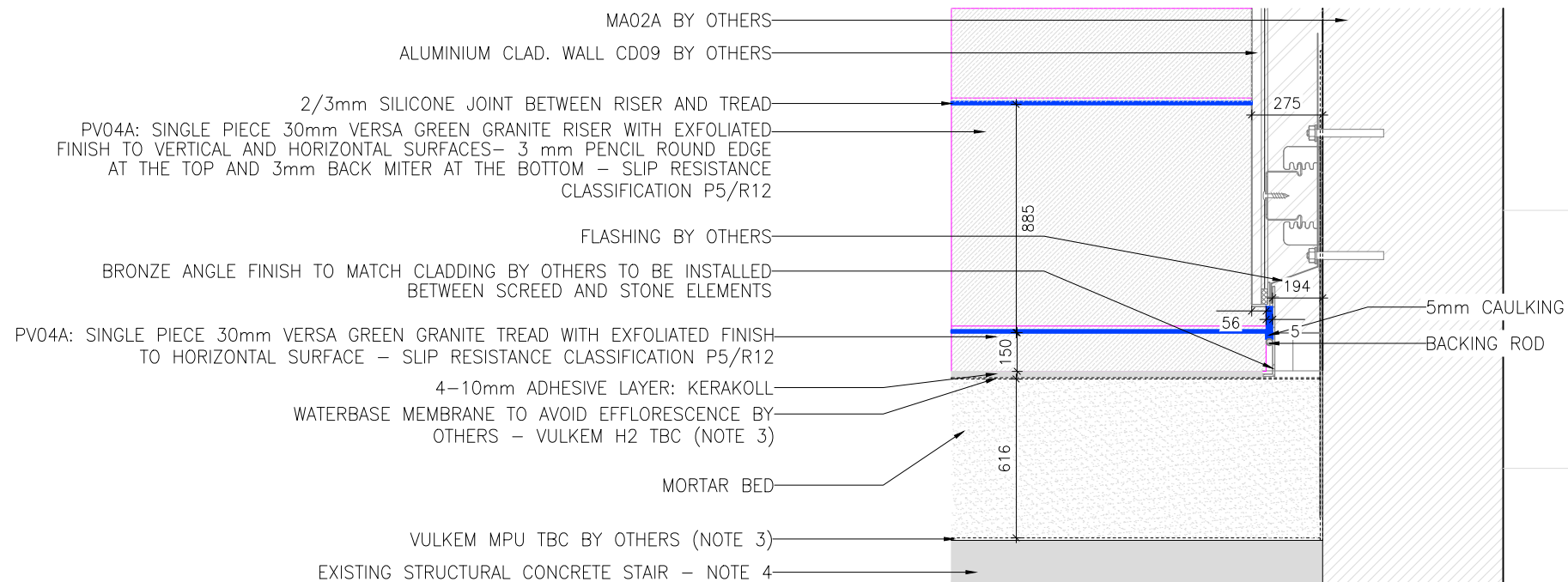

2 STAIR 13b WEST PLANT ROOM – LEVEL 7/8
SECTION DETAIL 1:5

ABSOLUTE
TILING & STONE

Level 7, 111 Elizabeth St.
Sydney CBD
Ph. (02) 9896 7727
www.versatile.com.au

LEGEND:

- 30mm EXFOLIATED VERSA GREEN GRANITE TREADS AND RISERS
- 30mm SANDBLASTED TURKISH TRAVERTINE NOSING
- PV01/PV11a 900x900x30 FLAMED VERSA GREEN GRANITE
- SILICONE EXP JOINT. COLOR TBC
- TILE SET OUT POINT
- BLACK VERSATILE NEW FFL
- RED VERSATILE SURVEYED SUBSTRATE

KEY PLAN:

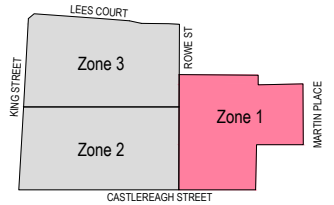

NORTH POINT:

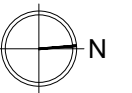

PROJECT:

MLC RETAIL
REDEVELOPMENT STAGE 2

CLIENT:

PROBUILD

Project number:
ATS-286

Project name
MLC RETAIL
REDEVELOPMENT STAGE 2

Drawing name
STAIR 13b STONE WORKS
SHEET 2

Drawing number
ATS-A-232







Scale	AS SHOWN @A3
Revision	3
Date	04.02.2021
Drawn	HH
Issued for	CONSTRUCTION

General Notes:

- Check all dimensions on site prior to commencement of construction
- Figured dimensions to take precedence over scaled dimensions
- All works to be in accordance with BCA, Australian Standards, statutory regulations and local authority requirements
- Contractor to confirm structural integrity, stability and feasibility of all units/components prior to manufacture
- Contractor to liaise with 3rd party suppliers to confirm exact requirements including electrical, date, comms and hydraulic requirements and access points

1. ALL DESIGN AND MEASUREMENTS HAVE BEEN TAKEN FROM BASE BUILDING DRAWINGS, DISCREPANCIES BETWEEN DRAWINGS AND SITE CONDITIONS ARE NOT THE SUBCONTRACTOR'S RESPONSIBILITY. ANY COST TO RECTIFY DISCREPANCIES BETWEEN BASE BUILDING DRAWINGS AND SITE CONDITION WILL NOT BE BORNE BY ATS
2. LOCATION OF ALL NEW AND EXISTING SERVICES HAVE BEEN TAKEN FROM CONSULTANTS DRAWINGS
3. BUILDER TO CONFIRM EXISTING AND NEW WATERPROOFING SYSTEM IS ADEQUATE AND MEETS CODE AND RELEVANT AUSTRALIAN STANDARDS PRIOR TO ANY TILING WORK COMMENCING
4. C.O.S. LINE OF EXISTING CONCRETE. STRUCTURAL ENGINEER TO CHECK AND APPROVE PRIOR TO REMOVAL OF EXISTING STRUCTURE BELOW
5. SOP AT TOP RIGHT CORNER OF THE TILE (AS SHOWN ON ALL DRAWINGS)
6. HYDRAULIC CONSULTANT TO PROVIDE ADVICE ON DRAINAGE STRATEGY ON STAIR

Level 7, 111 Elizabeth St.
Sydney CBD
Ph. (02) 9896 7727
www.versatile.com.au

	50mmx65mm EXPOLATED VERSA GREEN GRANITE TREADS AND RISERS
	50mm SANDBLASTED TURKISH TRAVERTINE NOSING
	PVO1 900x900x30 FLAMED VERSA GREEN GRANITE
	TL03 1200x600x20 UNFILLED/HONED 200 TURKISH TRAVERTINE
	AUSTRAL BLACK TO FOLLOW COS PATTERN
	SILICONE EXP JOINT, COLOR TBC
	TILE SET OUT POINT

MLC RETAIL
REDEVELOPMENT STAGE 2

PROBUILD®

Project name
MLC RETAIL
REDEVELOPMENT STAGE 2

Drawing number
ATS-A-234

Scale	AS SHOWN @A3
Revision	1
Date	02.12.2020
Drawn	AA
Issued for	CONSTRUCTION

- Check all dimensions on site prior to commencement of construction
- Figured dimensions to take precedence over scaled dimensions
- All dimensions to be in accordance with BCA, Australian Standards, statutory regulations and local authority requirements
- Contractor to confirm structural integrity, stability and feasibility of all units/components prior to manufacture
- Contractor to liaise with 3rd party suppliers to confirm exact requirements including electrical, data, comms and hydraulic requirements and access points

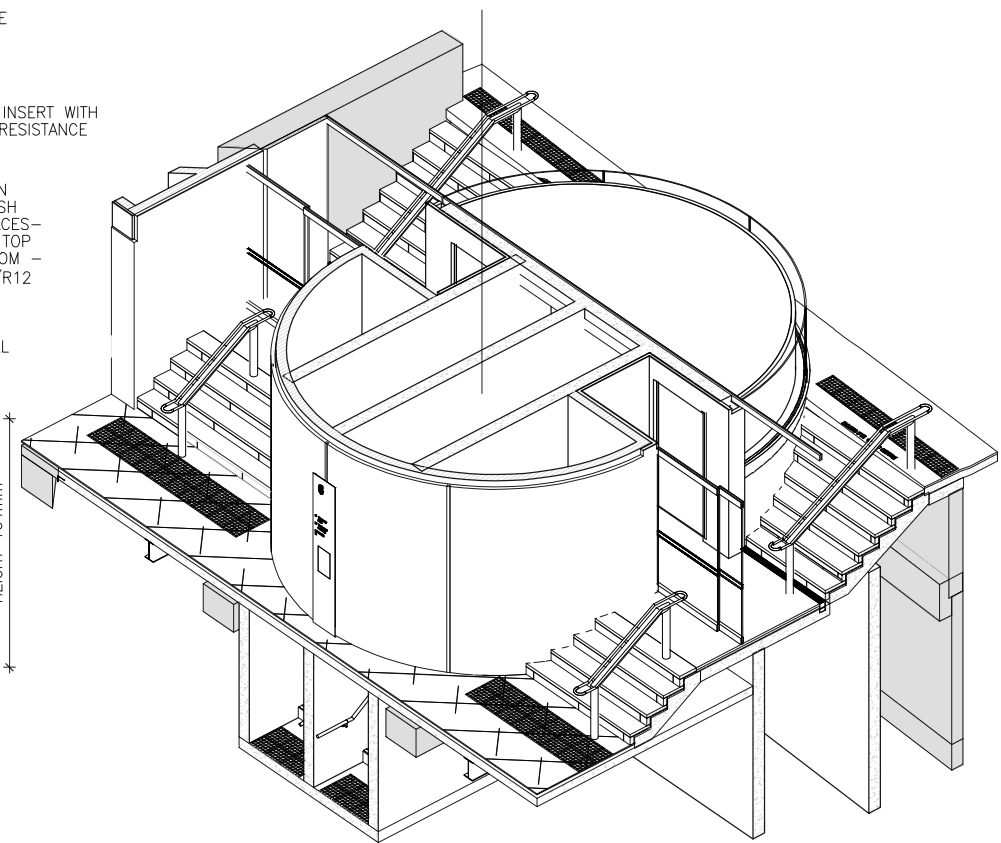

4	STAIR 11&12	
—	3D VIEW	NTS

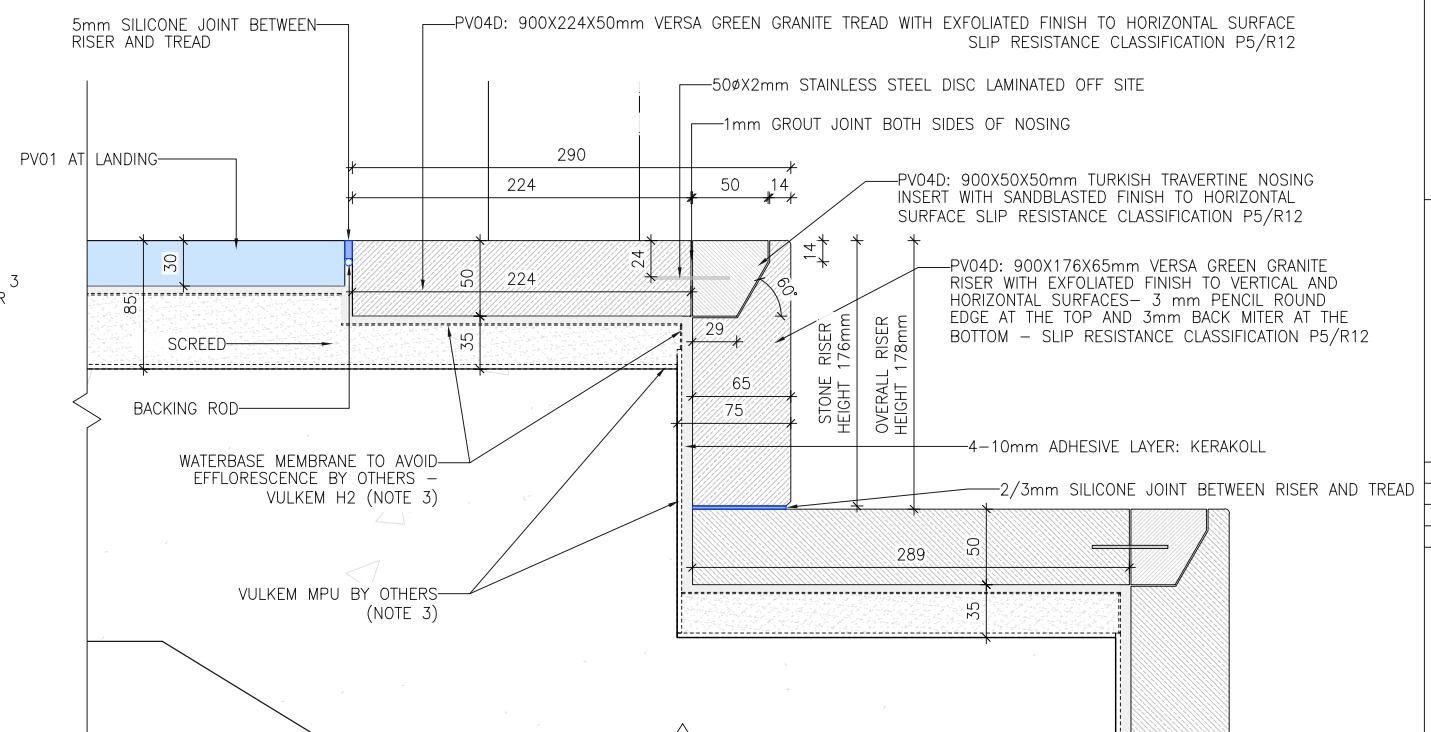

3 STAIR 11 & 12 – BOTTOM FLIGHT
221 SECTION DETAIL 1:5

NOTES:
1. ALL DESIGN AND MEASUREMENTS HAVE BEEN TAKEN FROM BASE BUILDING DRAWINGS, DISCREPANCIES BETWEEN DRAWINGS AND SITE CONDITIONS ARE NOT THE SUBCONTRACTOR'S RESPONSIBILITY. ANY COST TO RECTIFY DISCREPANCIES BETWEEN BASE BUILDING DRAWINGS AND SITE CONDITION WILL NOT BE BORNE BY ATS
2. LOCATION OF ALL NEW AND EXISTING SERVICES HAVE BEEN TAKEN FROM CONSULTANTS DRAWINGS
3. BUILDER TO CONFIRM EXISTING AND NEW WATERPROOFING SYSTEM IS ADEQUATE AND MEETS CODE AND RELEVANT AUSTRALIAN STANDARDS PRIOR TO ANY TILING WORK COMMENCING
4. C.O.S. LINE OF EXISTING CONCRETE. STRUCTURAL ENGINEER TO CHECK AND APPROVE PRIOR TO REMOVAL OF EXISTING STRUCTURE BELOW
5. SOP AT TOP RIGHT CORNER OF THE TILE (AS SHOWN ON ALL DRAWINGS)
6. HYDRAULIC CONSULTANT TO PROVIDE ADVICE ON DRAINAGE STRATEGY ON STAIR
7. ATS WARRANTS STEP DETAIL AND SUITABILITY



Level 7, 111 Elizabeth St.
Sydney CBD
Ph. (02) 9896 7727
www.versatile.com.au

LEGEND:

- 30mm/40mm EXFOLIATED VERSA GREEN GRANITE TREADS AND RISERS
30mm SANDBLASTED TURKISH TRAVERTINE NOSING
PV01 900x900x30 FLAMED VERSA GREEN GRANITE
PV02 600x60x30 UNFILLED/BRUSHED TURKISH TRAVERTINE
PV10 50mm EXFOLIATED GRANITE AUSTRAL BLACK
TL03 20mm CUSTOM SIZE UNFILLED /HONED 200 TURKISH TRAVERTINE
CD:03 900x900x40 EXFOLIATED VERSA GREEN GRANITE
SILICONE EXP JOINT. COLOR TBC
TILE SET OUT POINT

KEY PLAN:

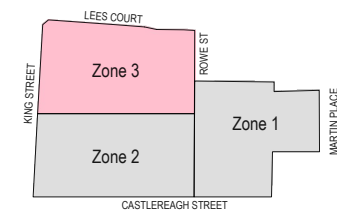

NORTH POINT:

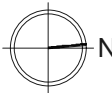

PROJECT:

MLC RETAIL
REDEVELOPMENT STAGE 2

CLIENT:

PROBUILD

Project number:
ATS-286

Project name
MLC RETAIL
REDEVELOPMENT STAGE 2

Drawing name
STAIR 4 STONE WORKS -
SHEET 3

Drawing number
ATS-A-237

Scale	AS SHOWN @A3
Revision	1
Date	07.12.2020
Drawn	AA
Issued for	CONSTRUCTION

General Notes:

- Check all dimensions on site prior to commencement of construction
- Figured dimensions to take precedence over scaled dimensions
- All works to be in accordance with BCA, Australian Standards, statutory regulations and local authority requirements
- Contractor to confirm structural integrity, stability and feasibility of all units/components prior to manufacture
- Contractor to liaise with 3rd party suppliers to confirm exact requirements including electrical, data, comms and hydraulic requirements and access points

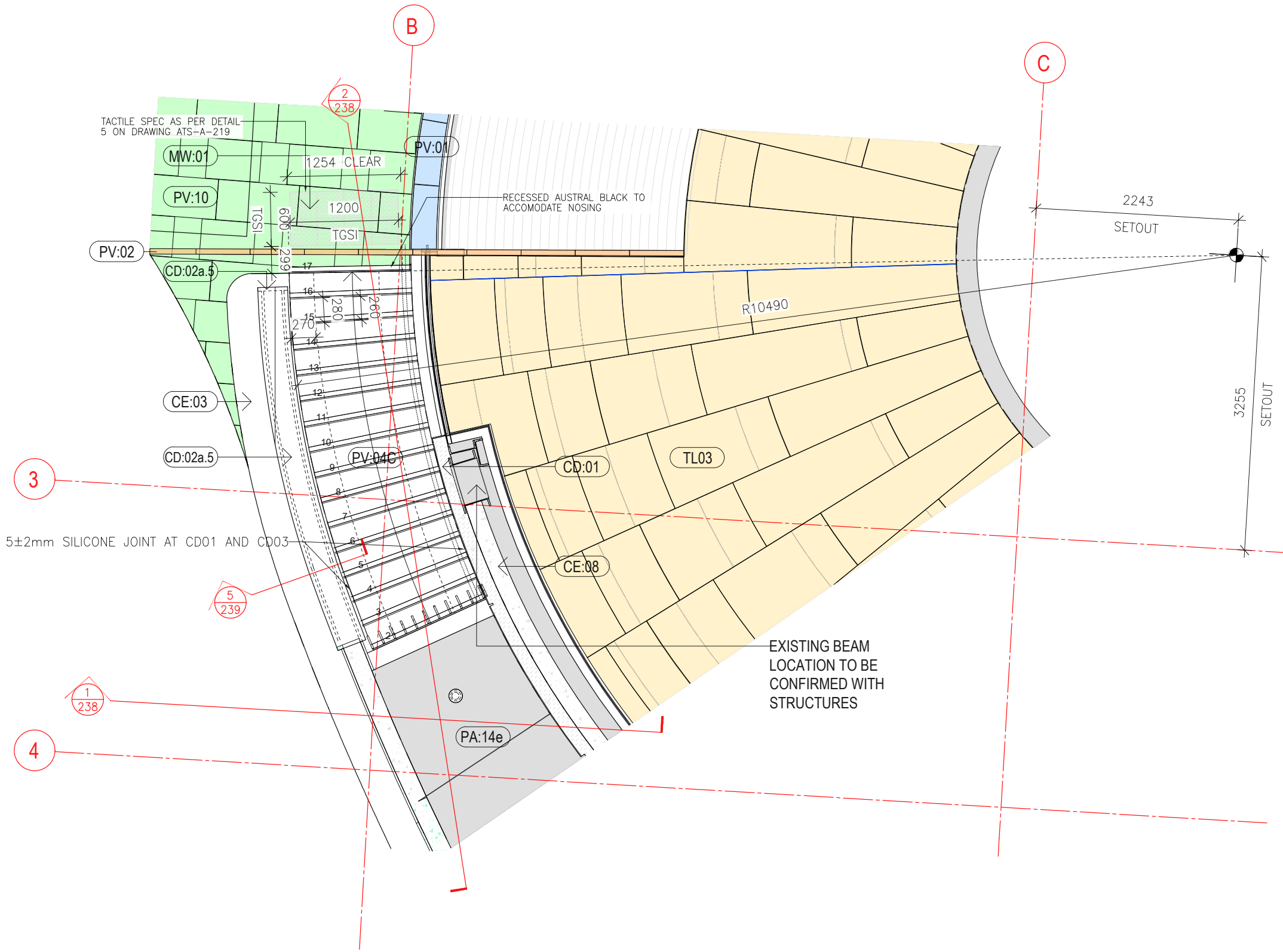

LEGEND:

- 30mm/40mm EXFOLIATED VERSA GREEN GRANITE TREADS AND RISERS
- 30mm SANDBLASTED TURKISH TRAVERTINE NOSING
- PV01 900x900x30 FLAMED VERSA GREEN GRANITE
- PV02 600x600x30 UNFILLED/BRUSHED TURKISH TRAVERTINE
- PV10 50mm EXFOLIATED GRANITE AUSTRAL BLACK
- TL03 20mm CUSTOM SIZE UNFILLED /HONED 200 TURKISH TRAVERTINE
- CD:03 900x900x40 EXFOLIATED VERSA GREEN GRANITE
- SILICONE EXP JOINT. COLOR TBC
- TILE SET OUT POINT

KEY PLAN:

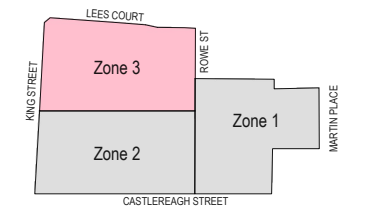

NORTH POINT:



PROJECT:

MLC RETAIL
REDEVELOPMENT STAGE 2

CLIENT:

PROBUILD

Project number:
ATS-286

Project name
MLC RETAIL
REDEVELOPMENT STAGE 2

Drawing name
STAIR 4 STONE WORKS -
SHEET 4

Drawing number
ATS-A-238

Scale	AS SHOWN @A3
Revision	3
Date	19.08.2021
Drawn	HH
Issued for	CONSTRUCTION

General Notes:

- Check all dimensions on site prior to commencement of construction
- Figured dimensions to take precedence over scaled dimensions
- All works to be in accordance with BCA, Australian Standards, statutory regulations and local authority requirements
- Contractor to confirm structural integrity, stability and feasibility of all units/components prior to manufacture
- Contractor to liaise with 3rd party suppliers to confirm exact requirements including electrical, date, comms and hydraulic requirements and access points

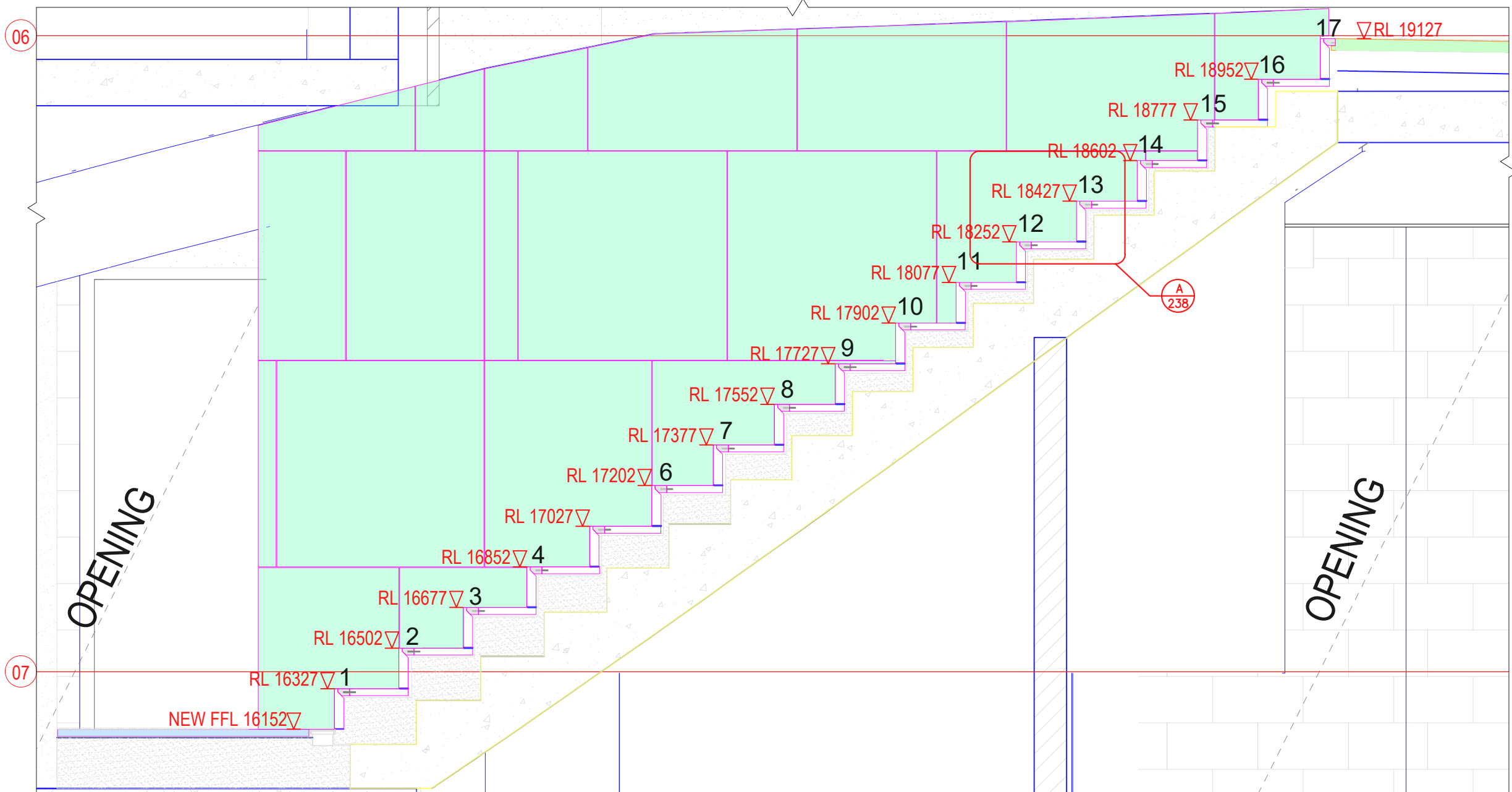

2 STAIR 4 - LEVEL 5/6
SECTION 1:20

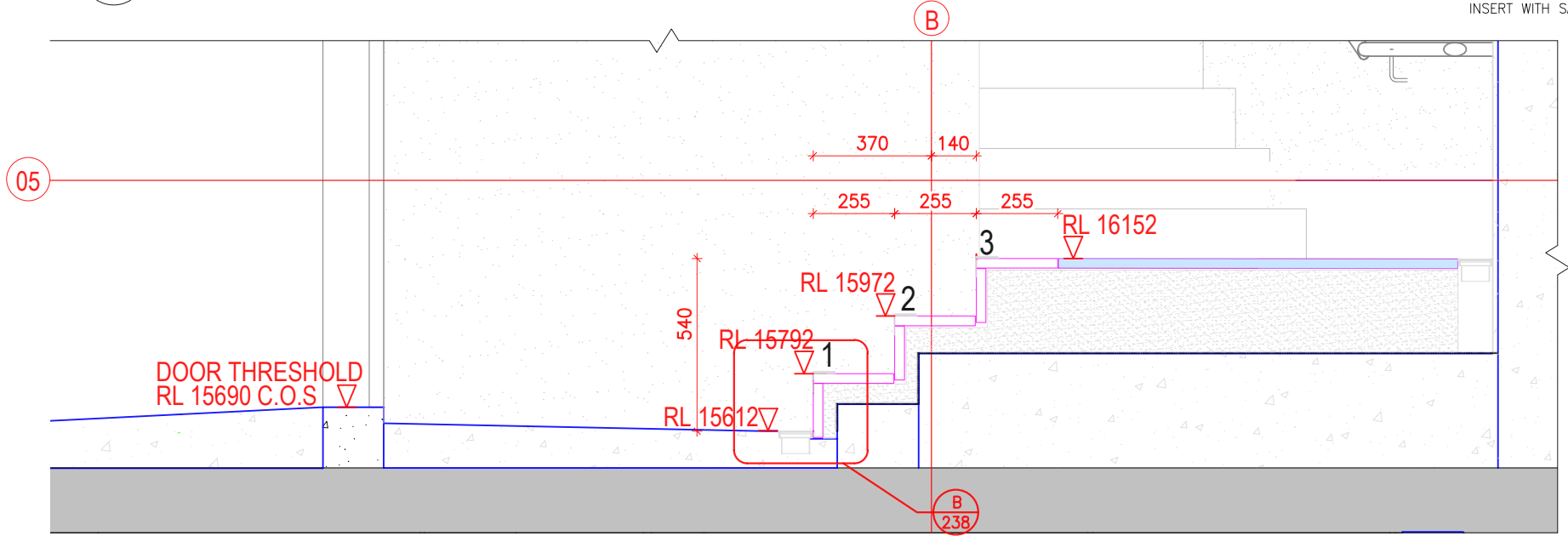

1 STAIR 4 - LEVEL 5/6
SECTION 1:20

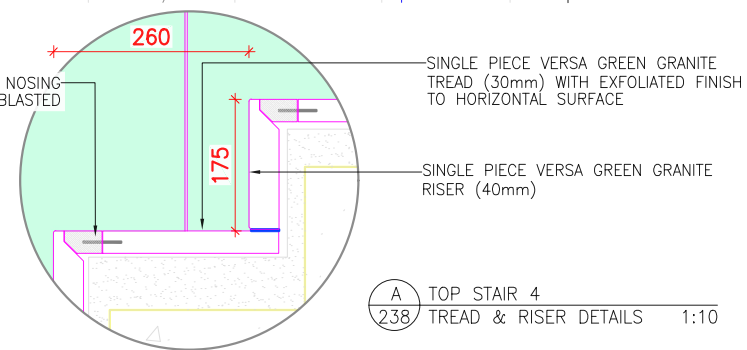

A TOP STAIR 4
TREAD & RISER DETAILS 1:10

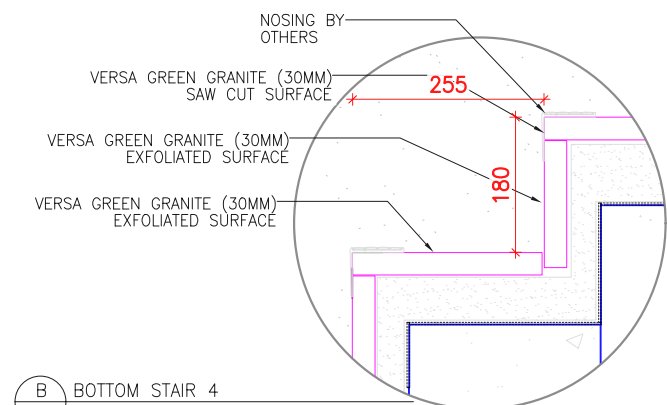

B BOTTOM STAIR 4
TREAD & RISER DETAILS 1:10